



established
1887
SUTCLIFFE
furniture

Hampton & Windsor
Collections



Where quality and distinction are the Sutcliffe standard...

Items shown on cover:
 Corner Unit 3819/6819
 and Sideboard 38491SB/68491SB
 Goodwood Dining Table with
 Droxford Dining Chairs

Items shown here:
 Dining Table 3990/6990
 Guildford Dining Chairs
 Display Unit 3933/6933
 Sideboard 38501SB/68501SB

Sutcliffe Furniture is a division of James H Sutcliffe & Son Ltd., a family owned furniture manufacturer based in the Pennines.

We have been manufacturing fine furniture here in Todmorden since 1887, drawing on the skills of generations of local craftsmen and women. We are proud of our history and heritage in British manufacturing.

The **Hampton** and **Windsor** collections are made with real wood and real wood veneers in either Mahogany or Cerise finish and bears all the hallmarks of traditional Sutcliffe craftsmanship.

The **Hampton** range is produced in warm rich hues of Mahogany, whilst the **Windsor** collection has more golden tones which bring out the beautiful natural grain of the timbers.

In this brochure we will show our extensive collection illustrating the comprehensive range of living, dining and occasional furniture.



**Manufacturing
 Guild Mark**



**GREAT
 BRITISH
 FURNITURE**
Member of the British Furniture Manufacturers Association

Colour Key

Hampton Prefix Number 3: ■
 Windsor Prefix Number 6: ■

Dining	3-4
Display	5-8
Living	9-10
Study	11-12
Visual	13-14
Audio	15
Occasional	16
Product Care	18



Windsor Dining

Items shown: Dining Table **3990/6990**
Linton Dining Chair, Display **3933/6933**
Tall Side Table **3916/6916**



Hampton Dining

Items shown: Dining Table **3239/6239**
Arran Dining Chair, Display Unit **3848/6848**
Hall Table **3893/6893**

This all-embracing Dining group offers a choice of seven dining tables with versatile options of drop leaf or extending flip centres and draw leaf extending tables to suit all dining room requirements.

To complement the dining tables, there is a selection of five dining chairs four with Carver (arm) options, all Sutcliffe chairs are made with solid frames with mortice and tenon joints to ensure longevity. For the finishing touch there is a comprehensive range of fabrics for that final personalised finish.



Extending Draw Leaf Dining Table 3990/6990 with Linton Chair
LO:150cm (59") LC:90cm (35 1/2") LHO:120cm (47 1/2")
W:90cm (35 1/2") H:79cm (31")
Linton Chair
H: 86cm (34")



Compact Round Dining Table 3239/6239 with Arran Chair and Carver
LO:138cm (54 1/2") LC:100cm (39 1/2")
W:100cm (39") H:77cm (30 1/2")
Arran Chair
H:96cm (37 1/2")



Goodwood Dining Table with Droxford Chair and Carver
LO:196cm (77") LC:143cm (56 1/2")
W:102cm (40") H:76cm (30 1/2")
Droxford Chair
H:99cm (39")



Oval Dining Table 3236/6236 with Trafalgar Chair and Carvers
LO:180cm (71") LC:141cm (55 1/2")
W:93cm (36 1/2") H:76cm (30")
Trafalgar Chair
H:100cm (39 1/2")



Dining Table 3930/6930 with Guildford Chair and Carver
LO:165cm (65") LC:120cm (48")
W:80cm (31 1/2") H:77cm (30 1/2")
Guildford Chair
H:100cm (39 1/2")



Drop-leaf Dining Table 3935/6935
1 Leaf Open:93cm (36 1/2") 2 Leaf Open: 150cm (59")
Leaf Closed:35cm (13 1/2") W:100cm (39 1/2") H:75cm (29 1/2")



Gate-leg Dining Table 3235/6235 with Arran Chair
1 Leaf Open:90cm (35 1/2") 2 Leaf Open: 150cm (59")
Leaf Closed:28cm (11") W:90cm (35 1/2") H:76cm (30")



Items shown: Display Unit 3863TG/ 6863TG
 Dining Table 3930/6930
 Guildford Dining Chair
 Tall Side Table 3916/6916

Display

The comprehensive range of wall and base units available within the Hampton and Windsor collection will enhance any room setting.



Display Unit 3863TG/6863TG
 H:188cm (74")
 W:160cm (63")
 D:47cm (18 1/2")
 Base H:77cm (30 1/2")
 Mirrored back optional
3863TGM/6863TGM



Combination Unit 3863/6863
 H:188cm (74")
 W:160cm (63")
 D:47cm (18 1/2")
 Base H:77cm (30 1/2")
 Mirrored back optional
3863M/6863M



Display Unit 3848/6848
 H: 188cm (74")
 W:121cm (47 1/2")
 D:47cm (18 1/2")
 Base H:77cm (30 1/2")
 Mirrored back optional
3848M/6848M



Combination Unit 3850/6850
 H:188cm (74")
 W:121cm (47 1/2")
 D:47cm (18 1/2")
 Base H:77cm (30 1/2")
 Mirrored back optional
3850M/6850M



Corner Unit 3819MS/6819MS
 H:188cm (74")
 Base H:66cm (26")
 Mirrors as standard

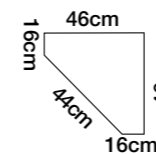

Corner Display Unit 3829/6829
 H:188cm (74")
 Mirrors as standard

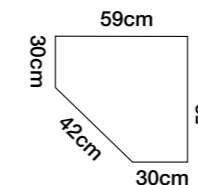

Display Unit 3833/6833
 H:188cm (74")
 W: 81cm (32")
 Base H:77cm (30 1/2")
 D:47cm (18 1/2")
 Mirrored back optional
3833M/6833M



Display Unit 3933/6933
 H:145cm (57")
 W 81cm (32")
 D:33.5cm (13")
 Mirrored back optional
3933M/6933M

Hampton and Windsor Display offer a comprehensive range of wall units and sideboards to enable you to both store items and show off those proud possessions to their best advantage. The cleverly concealed down lighting offers a subtle illumination which will further enhance your ornamental display.

All Base Units have half depth shelves as standard to outer cupboards.

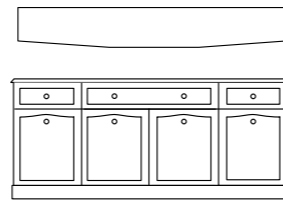

Sideboard 38631SB/68631SB
 H:77cm (30 1/2")
 W:160cm (63")
 D:49cm (19 1/2")

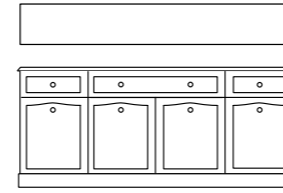

Base Unit 3863B/6863B
 H:77cm (30 1/2")
 W:160cm (63")
 D:47cm (18 1/2")

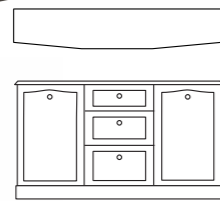

Sideboard 38491SB/68491SB
 H:77cm (30 1/2")
 W:121cm (47 1/2")
 D:49cm (19 1/2")

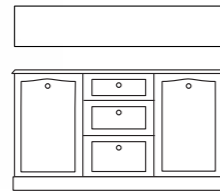

Base Unit 3849B/6849B
 H:77cm (30 1/2")
 W:121cm (47 1/2")
 D:47cm (18 1/2")

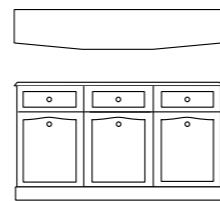

Sideboard 38501SB/38501SB
 H:77cm (30 1/2")
 W:121cm (47 1/2")
 D:49cm (19 1/2")

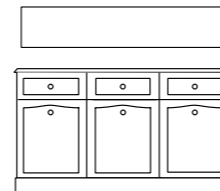

Base Unit 3850B/6850B
 H:77cm (30 1/2")
 W:121cm (47 1/2")
 D:47cm (18 1/2")



Base Unit 3833B/6833B
 H: 77cm (30 1/2")
 W: 81cm (32")
 D: 47cm (18 1/2")



Mirror 3900/6900
 Can be hung landscape or portrait
 100cm (39 1/2") x 77cm (30")



Display

Items shown: Sideboard **38491SB/68491SB**
 Table **3930/6930**
 Guildford Dining Chair

A comprehensive selection of Base Units and Sideboards is available in a variety of widths. A Sideboard will have a canted top and a Base Unit will have a parallel edged top.

With our attention to quality we use dove tail joints on all our drawers.

All Base Units and Sideboards have half depth shelves as standard to outer cupboards.

Both Sideboards and Base Units can have cutlery inserts as an optional extra.

Hampton and **Windsor** offer a bevelled glass Mirror **3900/6900** with a solid wood frame emulating the Collections which can be hung portrait or landscape.



Living

Items shown: Wide Screen TV Unit 3942/6942 Magazine Rack 3821/6821 Nest 3922/6922
Tall Side Table 3916/6916 Display Unit 3833/6833 Goodwood Dining Table with
Droxford Dining Chair, Bookcase 3252/6252 Chair from the Abbey Sofa Collection

Hampton and Windsor Living covers audio visual display and storage, library and home study and a large choice of those all essential occasional tables.



Study

Items shown: Console Table/Desk 3936/6936
 Bookcase with 2 Doors 3252/6252
 Tall Bookcase 3270/6270 Guildford Carver



Bookcase with 2 doors 3252/6252
 H:140cm (55")
 W:78cm (31")
 D:30cm (12")



Bureau 3923/6923
 H:100cm (39 1/2")
 W:82cm (32 1/2")
 D:47cm (18 1/2")
 Bureau comes with lock as optional extra



Console Table/Desk 3936/6936
 H:79cm (31")
 W:87cm (34 1/2")
 D:50cm (17 1/2")



Small Open Shelf Storage Unit 3248/6248
 H: 92cm (36") W: 48cm (19")
 D: 30cm (12")



Medium Open Shelf Storage Unit 3253/6253
 H: 122cm (48") W: 48cm (19")
 D: 30cm (12")



Small Bookcase 3238/6238
 H:92cm (36") W:78cm (31")
 D:30cm (12")



Medium Bookcase 3250/6250
 H: 122cm (48") W: 78cm (31")
 D: 30cm (12")



Tall Bookcase 3270/6270
 H: 184cm (72 1/2") W: 78cm (31")
 D: 30cm (12")

Collectors of Hampton and Windsor range will find this large selection of study furniture an asset for library and home IT equipment. It all complements the Hampton and Windsor range whilst being extremely functional too.

Hampton and Windsor bookcases all come in the same width but with a choice of heights.

All come with adjustable shelves to accommodate book height. Tall Bookcase 3270/6270 centre shelf is fixed.

The Bureau 3923/6923 and Console Desk Table 3936/6936 offer contemporary solutions for IT equipment.



Visual

Items shown: Entertainment Unit **3957/6957**
 Nest of Tables **3867/6867**
 Occasional Table with Magazine Rack **3821/6821**
 Chair from the Othello Sofa Collection



Corner TV/DVD Unit 3217/6217
 H:57cm (22½") W:100cm (39½")
 D:49cm (19½")
Internal
 H:43cm (17") W:43cm (17")
 D:39cm (15")



2 Door TV/DVD Unit 3832/6832
 H:49cm (19½") W: 77cm (30½")
 D:47cm (18½")
Internal
 H:34cm (13") W:67cm (26")
 D:39cm (15")



1 Drawer TV/DVD Unit 3834/6834
 H:49cm (19½") W:80cm (31½")
 D:47cm (18½")
Internal
 H:17.5cm (7") W:70cm (27½")
 D:42cm (16½")



TV/DVD Unit for Widescreen TV 3942/6942
 H:51cm (20") W:100cm (39½") D:46cm (18")
Internal
 H:40cm (16") 2 adjustable shelves
 in each compartment
 W:44cm (17½") D:42cm (16½")



Entertainment Unit for Widescreen TV 3957/6957
 H:51cm (20") W:146cm (57½")
 D:46cm (18½")
Internal
 H:40cm (16") 2 adjustable shelves
 in each compartment
 W:44cm (17½") D:42cm (16½")



Items shown: Corner TV/DVD Unit **3218/6218**
 Gate Leg Coffee Table **3924/6924**
 Low-6 Drawers Unit **3234/6234**
 Chair from the Abbey Sofa Collection

Corner TV/DVD Unit 3218/6218
 H:56cm (22") W:113cm (44½") D:60cm (24")
Internal
 H:43cm (17") W:43cm (17") D:39cm (15")

Low 6 - Drawers Unit 3234/6234
 H:56cm (22") W:79cm (31") D:46cm (18")

Low Single Door Unit 3231R/6231R (Right Hand Hinge)
 H:56cm (22") W:39cm (15½") D:46cm (18")
Low Single Door Unit 3231L/6231L (Left Hand Hinge)
 H:56cm (22") W:39cm (15½") D:46cm (18")

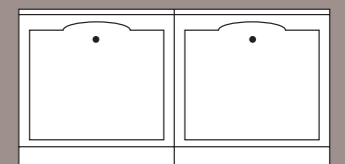

Low 2-Door Unit 3232/6232
 H:56cm (22") W:79cm (31")
 D:46cm (18")

All internal measurements are given to accommodate media equipment.



CD/DVD Storage Unit
3815/6815
H:81cm (32")
W:48cm (19")
D:22cm (8 1/2")

CD/DVD Storage Unit with shelves
3818S/6818S
H:81cm (32")
W:64cm (25 1/2")
D:23cm (9")

CD/DVD Storage Unit with racks
3818/6818
H:81cm (32")
W:64cm (25 1/2")
D:23cm (9")



Audio Visual Storage Cabinet 3220/6220
H:84cm (33") W:48cm (19") D:49cm (19 1/2")
Internal
H:71cm (28") W:37cm (14 1/2") D:43cm (17")



CD/DVD Storage Unit
3822/6822
H:92.5cm (36 1/2")
W:55cm (21 1/2")
D:36.5cm (14 1/2")



Sofa Table 3928/6928
H:51cm (20") W:120cm (47")
D:58cm (23")



Coffee Table 3918/6918
H:43cm (17") W:100cm (39")
D:46cm (18")



Tall Side Table 3916/6916
H:78cm (31") W:45cm (17 1/2")
D:40cm (15 1/2")



Hall Table 3893/6893
H:78cm (31") W:84cm (33")
D:38cm (15")



Sofa Table with pull-out heat resistant sides 3835/6835
H:51cm (20") OW:143cm (56 1/2")
CW:90cm (35 1/2") D:46cm (18")



Gate Leg Coffee Table 3924/6924
1 Leaf Open:66cm (26") 2 Leaf Open:100cm (39 1/2")
Leaf Closed:33cm (13") W:62.5cm (25") H:51cm (20")



Nest of Tables 3922/6922
H:47cm (18 1/2") W:55cm (22")
D:44cm (17")



Lamp Table 3820/6820
H:51cm (20") W:52cm (20 1/2")
D:46cm (18")



Occasional Table with Magazine Rack 3821/6821
H:50cm (19 1/2") W:52cm (20 1/2")
D:33cm (13")



Nest of Tables 3867/6867
H:51cm (20") W:52cm (20 1/2")
D:46cm (18")



Glass Top Sofa Table 3947G/6947G
H:50cm (19 1/2") W:114cm (45")
D:50cm (19 1/2")



Sofa Table 3947/6947
H:50cm (19 1/2") W:114cm (45")
D:50cm (19 1/2")



Large supper table 3844/6844
H:41cm (16") W:113cm (44 1/2")
D:64cm (25 1/2")

Audio

From Sound Systems to Hi-Fi Systems, Hampton and Windsor display and stores DVDs and CDs.

Occasional

Beautiful Hampton and Windsor has over twelve occasional tables to choose from. With a choice of tall, hall, coffee, sofa, nest and magazine rack with table.

Why Sutcliffe Furniture?

We believe we have ten good reasons...

- Proud of our heritage, we have been producing furniture since 1887.
- Collectors of Hampton and Windsor will find a piece of furniture to suit every need.
- We have been awarded the prestigious Guild Mark for Furniture design and manufacture.
- All our furniture is British designed and manufactured.
- All our timbers are sourced from sustainable forests.
- Hampton and Windsor are continually evolving creating new cabinet to meet modern home needs.
- It is collectable.
- We use dove tail joints in all our drawers.
- We use mortice and tenon joints in all our chair joints.
- All timbers and veneers are hand selected.

Items shown: Bureau 3923/6923 Trafalgar Chair

Care of cabinet

To keep your cabinet in good condition, we recommend that, in addition to regular dusting with a soft clean duster, an occasional wipe with a chamois leather rinsed in a mild detergent solution is beneficial.

Any spillage should be removed at once. Proprietary sprays and polishes MUST NOT BE USED.

Please avoid heat and rough objects which may scratch the surface of the furniture.

Further instructions regarding your particular item of furniture are attached to each individual item where applicable.

Wood is a natural material and so will vary in grain and colour.

Wood will mellow subtly with age.

Hampton and Windsor offers a choice of two handles one as shown in the wood with the pewter trim and another same style but all wood.

All measurements are approximate.

Specifications

All Tall Units, Sideboards/Base Units and Occasional Furniture, now include solid hard wood, dovetailed drawers with self closing easy glide runners.

All Tall Units, Base Units/Sideboards have half depth shelves to the outer cupboards as standard.

A large selection of covers are available for Dining Chairs, some (G/H Level) will include an optional extra cost.

It is our policy to improve our products and minimise costs, and so reserve the right to alter our specification without notice. The beauty of natural wood means that no two pieces are identical and therefore an exact match cannot be guaranteed.



GREAT
BRITISH
FURNITURE
Member of the British Furniture Manufacturers Association



Manufacturing
Guild Mark

Abbey Sofa



Why not ask your local stockist about other fabulous Sutcliffe furniture collections and request a brochure or download one from our website www.sutcliffefurniture.co.uk to see our

other stunning ranges of furniture:

Trafalgar, Kensington Ash/Acorn, Amberley and Upholstery

established
1887
SUTCLIFFE
furniture

Frostholme Mill, Burnley Road
Todmorden, Lancashire, OL14 7ED

T: 01706 815133

F: 01706 818701

E: sales@sutcliffegroup.co.uk

www.sutcliffefurniture.co.uk

